

MASTER PLAN

COMMUNITY UPDATE | February 2021



WHAT'S IN THIS UPDATE

We are about to embark on an extension of the facilities for Primary.

It is anticipated that the project will be completed towards the end of Term 3, well before the commencement of the 2022 College year.

During construction of the infill building, there will be no access to the K-6 Hall carpark.

PRIMARY PROJECT 2020/21

David Jennings – Business Manager

A new year brings new beginnings for many of us. None more so than the new students and families we have welcomed into our community this year. We hope that the students settle in quickly and enjoy the environment that William Clarke College provides to learn and grow.

As a result of the College's continued growth towards a full four streams from Kindergarten to Year 6, we are about to embark on an extension of the facilities for Primary.

We are grateful to God for answered prayer. You may remember in our last Masterplan update that the Primary Project commencement was being held up by a Transport for NSW interim decision. Thankfully, the issues being considered by Transport for NSW were resolved, and we were given the approval to proceed with the project just prior to Christmas.

The College has appointed Rohrig Constructions as the builders for this project. Having worked with us recently as the builders of the Branwhite Centre, they are familiar with the College.

Rohrig took possession of the Primary Project building site on 29 January 2021, with physical construction work to commence on 15 February 2021.

It is anticipated that the project will be completed towards the end of Term 3, well before the commencement of the 2022 College year. This will allow us time to set up the rooms with furniture, equipment and resources.

“

As a result of the development, three specialist spaces for Art, Science and Music will be incorporated into the Primary School area.

”

The Project components are:

1. Infill between the K-6 Hall and the existing Primary School building. In this area we will be creating six (6) new classrooms with additional breakout spaces.
2. Enclosing a balcony area. On the top level of the Primary building directly above Kindergarten Navy, this terrace area will be enclosed, and a classroom created.
3. Renovating classrooms adjacent to the Primary School car park. These will eventually form the Kindergarten precinct, providing a closer connection and transition from the Preparatory precinct.

As a result of the development, three specialist spaces for Art, Science and Music will be incorporated into the Primary School area.

During construction of the infill building, there will be no access to the K-6 Hall carpark. At the conclusion of the project, access will be re-opened with car parking spaces being restored under the new building.

We ask during the construction of these spaces that our community is patient, especially with regards to the traffic around the College. We also pray that God will keep everyone safe during the construction of these spaces.

David Jennings
Business Manager

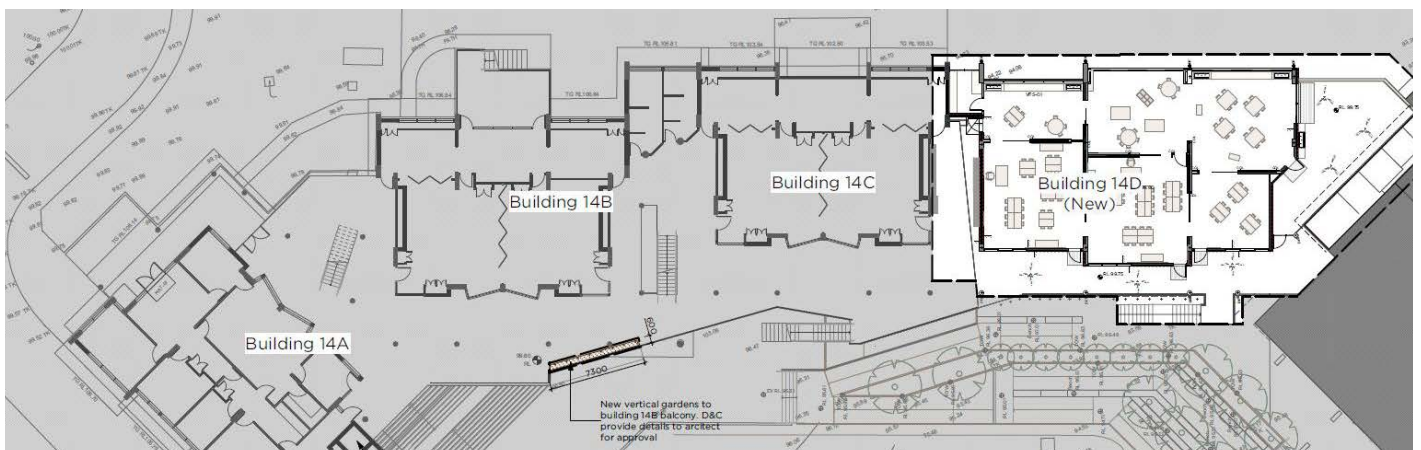

Upcoming changes for the Primary School, including new classrooms (14D), an enclosed terrace area, renovation work to a number of existing classrooms and aesthical changes to the playground.